

SCHOOL DISTRICT OF



FORT • ATKINSON

FAC Meeting No. 3 | 19 November 2019



CGSCHMIDT

pra

PLUNKETT RAYSICH
ARCHITECTS, LLP

call to order

Welcome!



SCHOOL DISTRICT OF



FORT • ATKINSON

AGENDA

Tuesday, November 19, 2019

Meeting 3 (November 19, 2019): Educational Space Analysis & Collaborative Learning Spaces

1. Call to Order – Co-Chairs
 - a. Review of Agenda and Upcoming Meetings
 - b. Questions from Previous Meeting
2. Existing Space Utilization – PRA
3. Curriculum Development & Special Education Facility Needs – FASD
4. Collaborative Learning Spaces & Flexible Furniture – PRA / FASD
5. Tour High School – ALL

NEXT MEETING: December 17, 2019 @ Barrie Elementary



existing space utilization



SCHOOL DISTRICT OF



FORT • ATKINSON

Educational Capacity

Determined by several factors

- Student to teacher ratio
- National operational efficiency rates
- Number of learning spaces available



Student Ratio

- PK / 4K 18:1
- K – 2nd 24:1
- 3rd – 5th 26:1
- 6th – 8th 30:1
- 9th – 12th 30:1



Barrie Elementary



SECOND FLOOR

1/32" = 1'-0"



FIRST FLOOR

1/32" = 1'-0"



LOWER LEVEL

1/32" = 1'-0"

PRA Color Legend

- | | | |
|---|---|--|
| Circulation | Library/Success Center | Special Education |
| General Classrooms | Offices | Student Commons/Cafeteria |
| Gymnasium, Pool, Fitness | Service/Public Toilets | |

Facilities Advisory Committee

Barrie Elementary

Barrie Elementary School Enrollment History

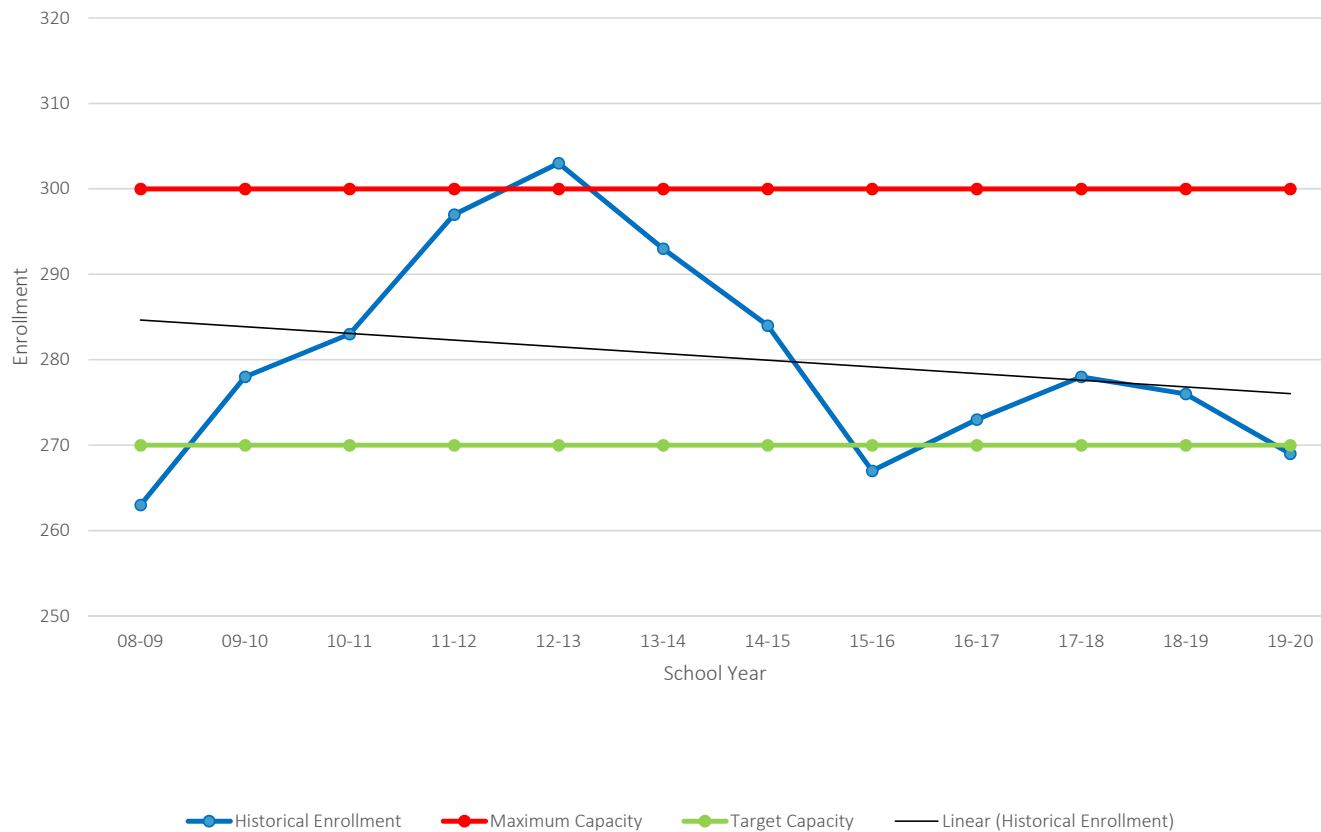



- Max Capacity ~ 300
- Target Capacity ~ 270
- 19/20 Enrollment = 269
- 2 Section School

FIRST FLOOR
1" = 40'-0"

PRA Color Legend

- Circulation
- Daycare
- General Classrooms
- Gymnasium, P
- Library/Success
- Offices

- Circulation
- Daycare
- General Classrooms

-  Gymnasium, Pool, Fitness
-  Library/Success Center
-  Offices

-  Service/Public Toilets
-  Special Education
-  Specials

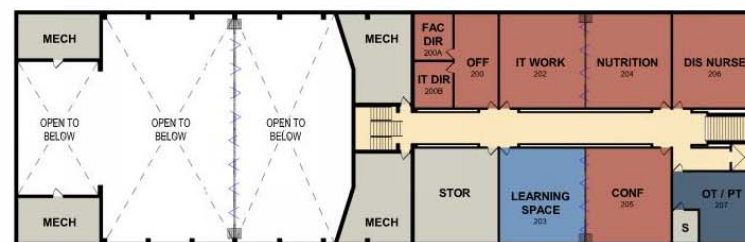

SECOND FLOOR

1" = 40'-0"

Luther Elementary

Luther Elementary School Enrollment History

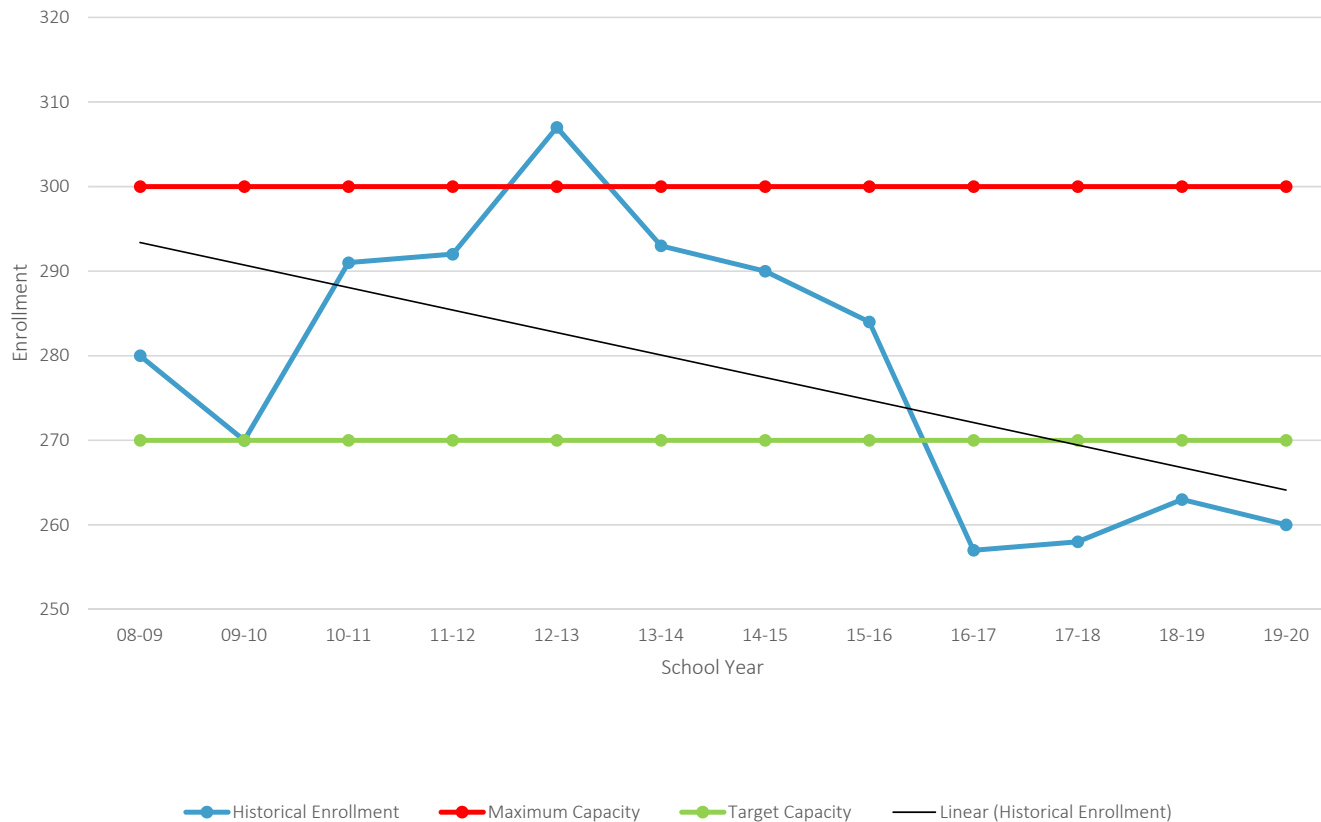

- Max Capacity ~ 300
- Target Capacity ~ 270
- 19/20 Enrollment = 260
- 2 Section School

Purdy Elementary



Facilities Advisory Committee

Purdy Elementary

Purdy Elementary School Enrollment History

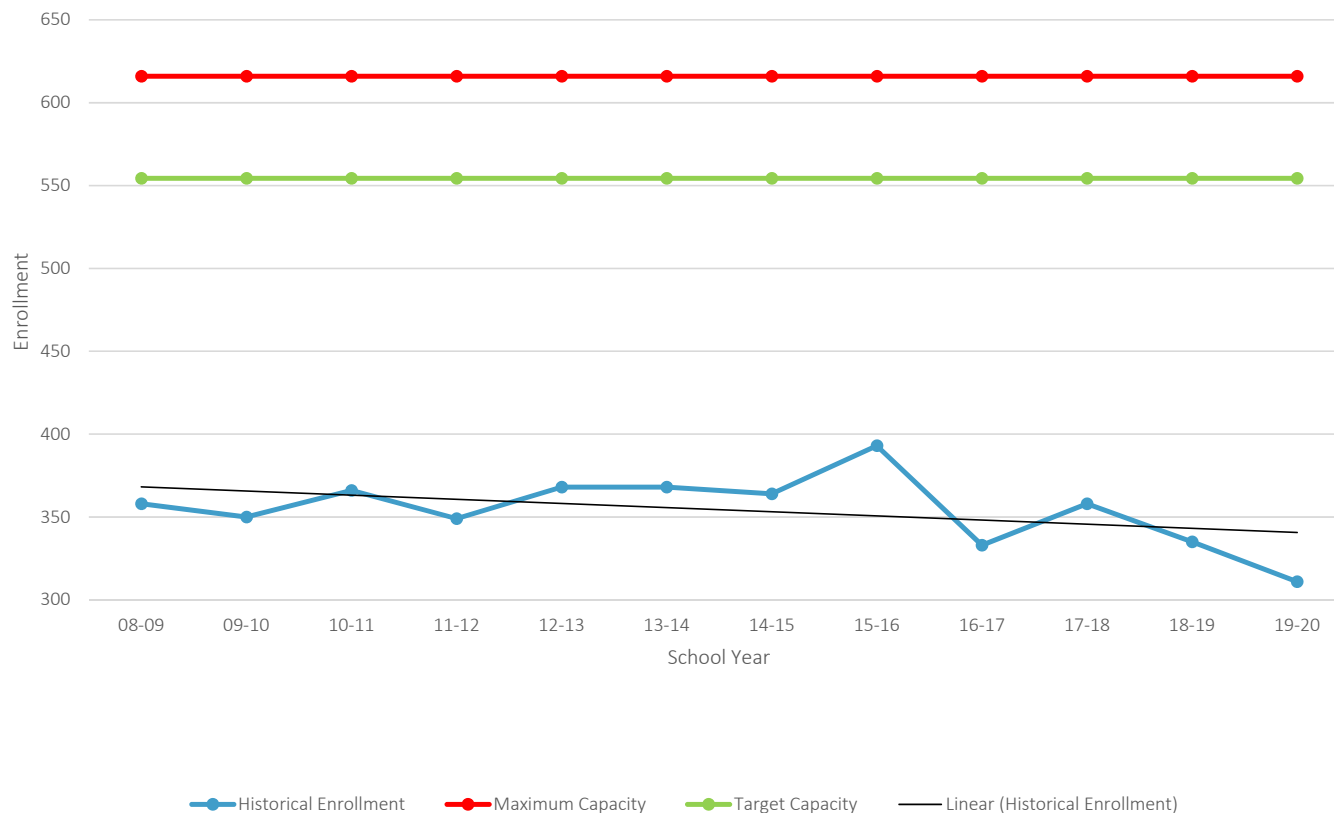

- Max Capacity ~ 616
- Target Capacity ~ 554
- 19/20 Enrollment = 311
- 2 Section School
- Multiple potential classrooms

Rockwell Elementary

LOWER LEVEL
1/32" = 1'-0"

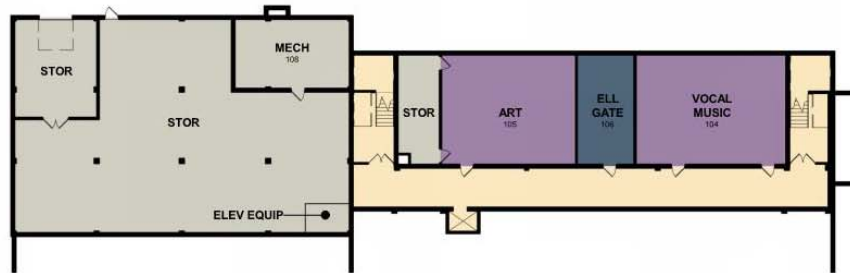

FIRST FLOOR
1/32" = 1'-0"



PRA Color Legend

- | | | |
|---|---|--|
| Circulation | Library/Success Center | Special Education |
| General Classrooms | Offices | Student Commons/Cafeteria |
| Gymnasium, Pool, Fitness | Service/Public Toilets | |

Facilities Advisory Committee

Rockwell Elementary

Rockwell Elementary School Enrollment History

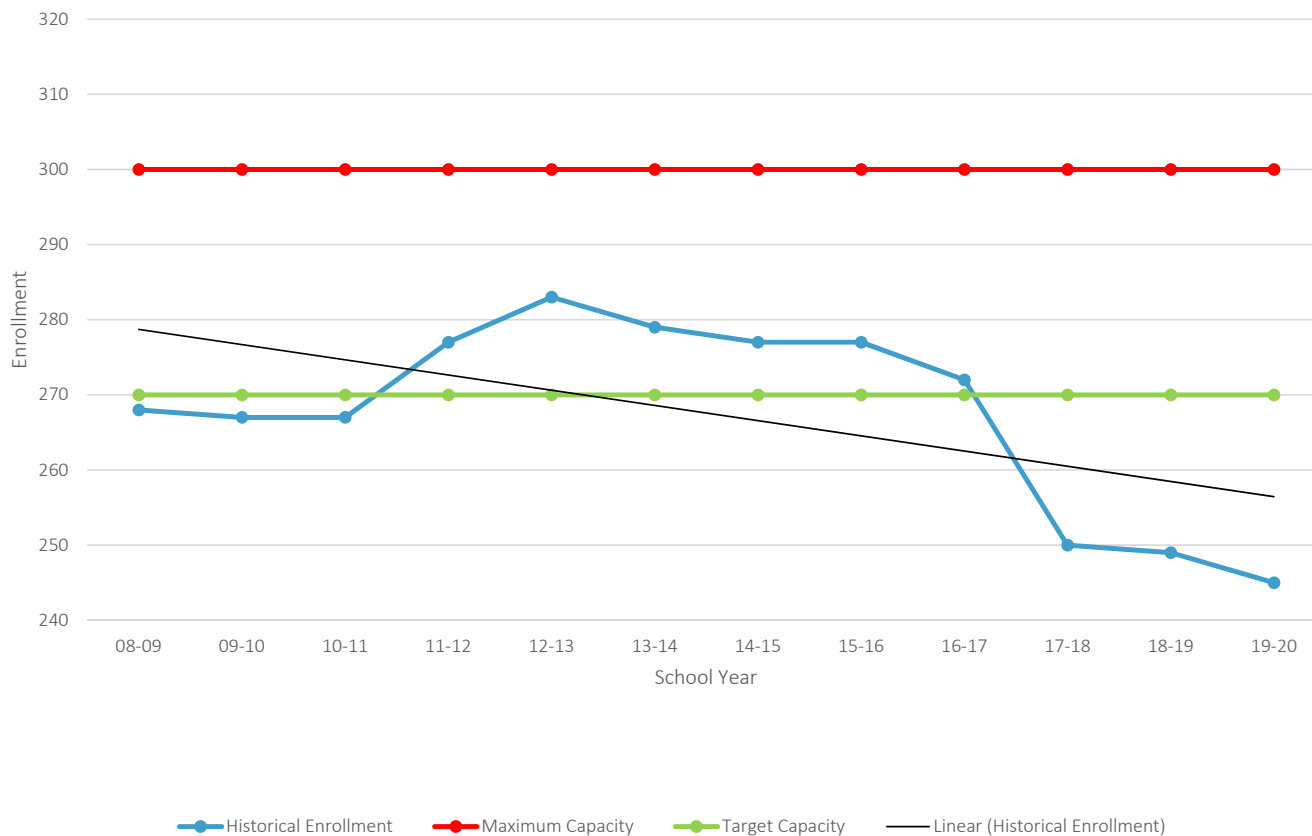

- Max Capacity ~ 300
- Target Capacity ~ 270
- 19/20 Enrollment = 245
- 2 Section School

Fort Atkinson Middle School

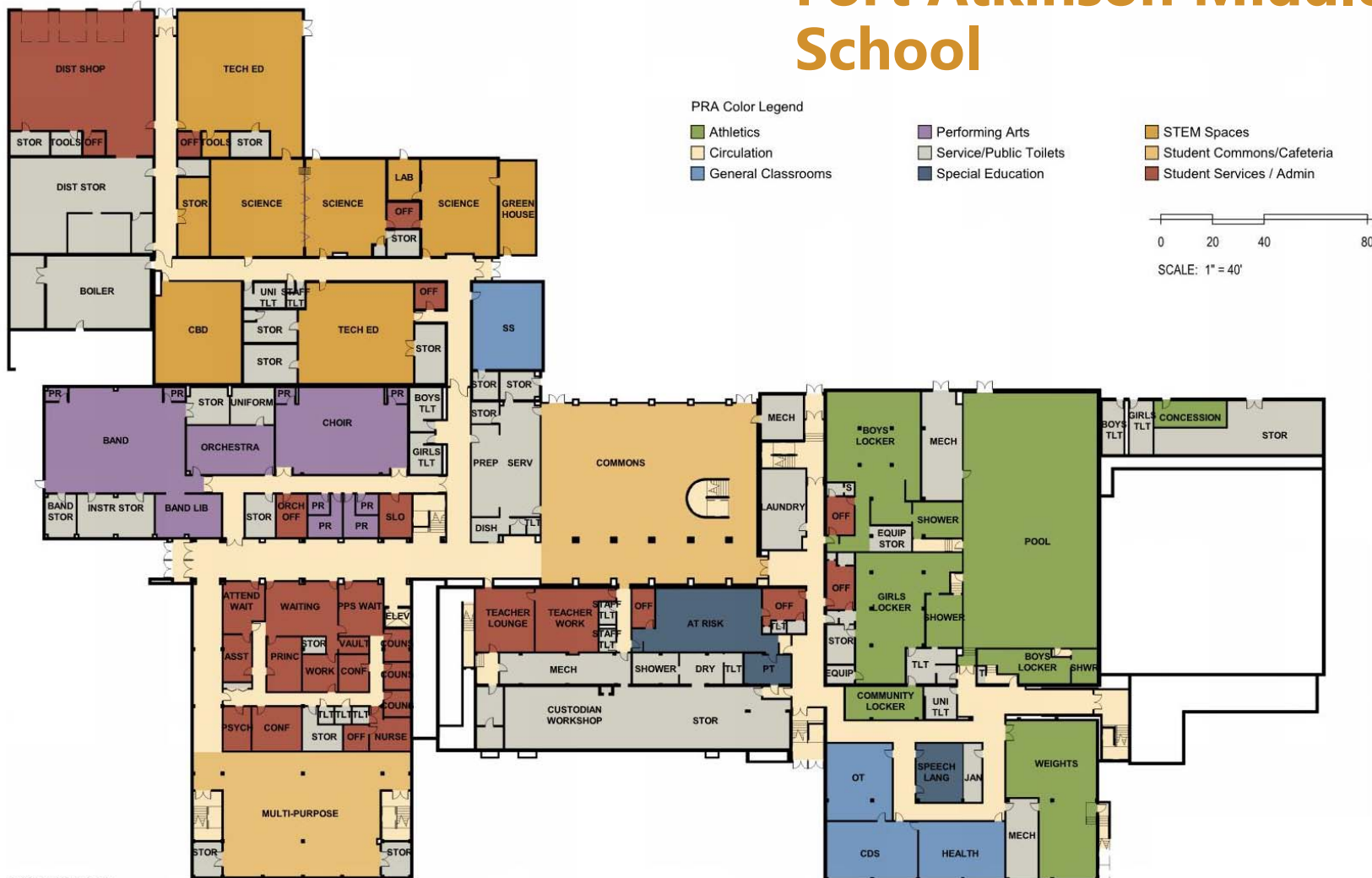

Fort Atkinson Middle School



Fort Atkinson Middle School



TRUE NORTH
PLAN NORTH
SECOND FLOOR
1" = 40'-0"

Fort Atkinson Middle School

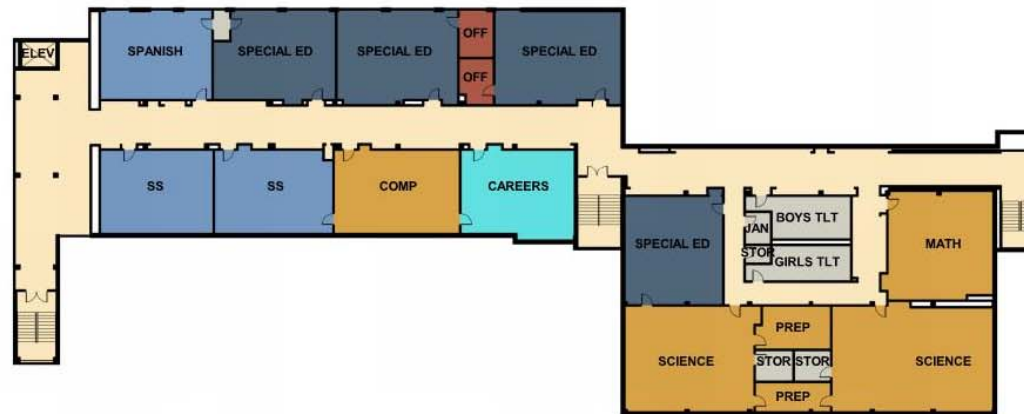
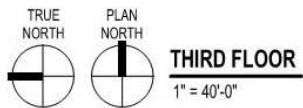

Fort Atkinson Middle School

Enrollment Capacity based on Maximum and Target Class Size

Num of Rooms	Program	Periods Per Day	Periods Used	Usage Factor	Target Class Size	Maximum Capacity	Efficiency Factor	Target Capacity
6	English Classrooms	8	6	75%	30	135	85%	115
8	Math Classrooms	8	6	75%	30	180	85%	153
4	Social Studies Classrooms	8	6	75%	30	90	85%	77
5	Science	8	6	75%	30	113	85%	96
23								
3	Phy-ed Stations	8	7	88%	30	79	85%	67
1	Pool	8	7	88%	30	26	85%	22
1	Weight / Fitness	8	7	88%	30	26	85%	22
2	Health Classroom	8	2	25%	30	15	85%	13
1	Spanish Classrooms	8	6	75%	30	23	85%	19
3	CTE / Engineering Labs	8	6	75%	30	68	85%	57
1	FACE	8	6	75%	30	23	85%	19
1	Business Education	8	6	75%	30	23	85%	19
2	Art	8	6	75%	30	45	85%	38
1	Band	8	3	38%	50	19	85%	16
1	Orchestra	8	3	38%	26	10	85%	8
1	Choir	8	3	38%	50	19	85%	16

	Maximum Capacity	Target Capacity
Building Capacity	891	757

- Type of space
- Periods used per day
- Students per scheduled period
- Efficiency Factor
- Target Capacity
- Maximum Capacity

Fort Atkinson Middle School

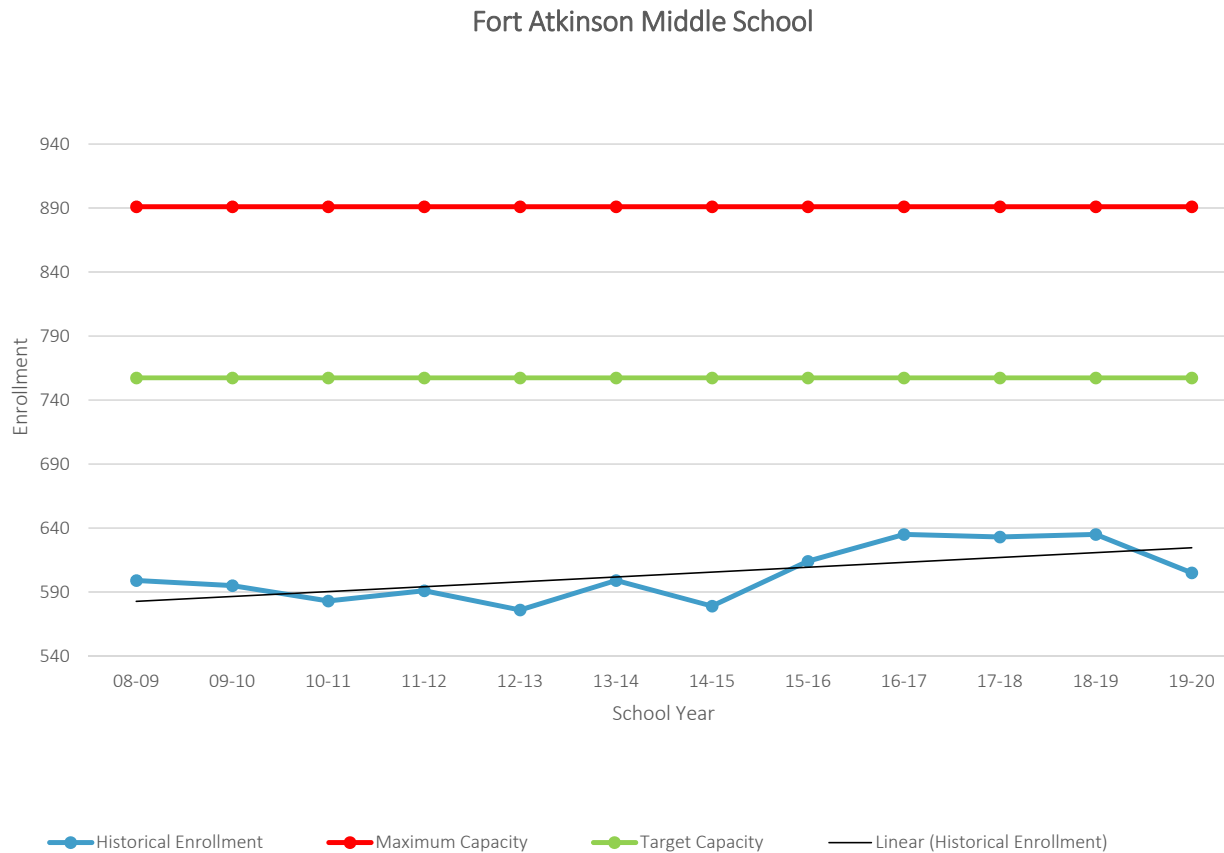

- Max Capacity ~ 891
- Target Capacity ~ 757
- 19/20 Enrollment = 605
- Potential added capacity w/ space reassignment

Fort Atkinson High School



Facilities Advisory Committee

Fort Atkinson High School

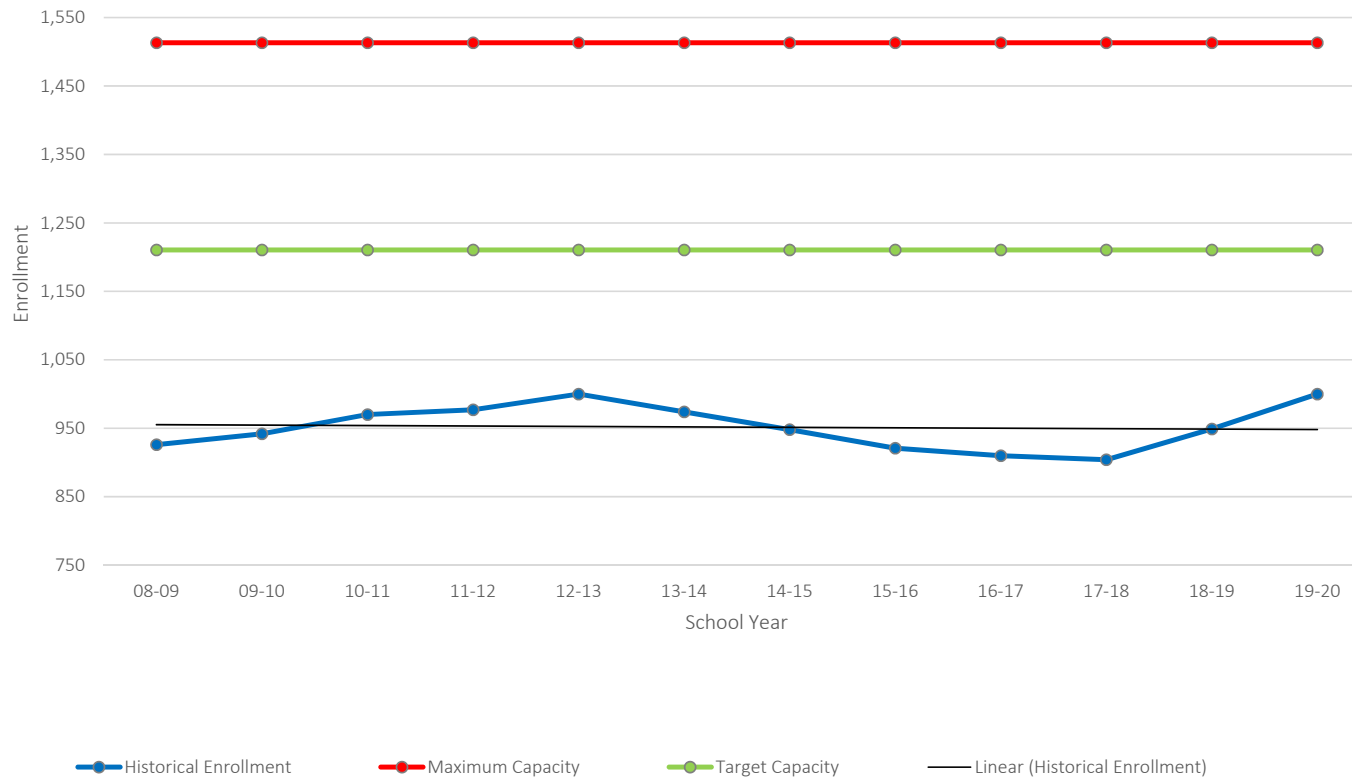

- Target Capacity ~ 1,211
- Max Capacity ~ 1,513
- 19/20 Enrollment = 1,000

curriculum & special education



SCHOOL DISTRICT OF



FORT • ATKINSON

What is today's **OPTIMAL LEARNING ENVIRONMENT?**



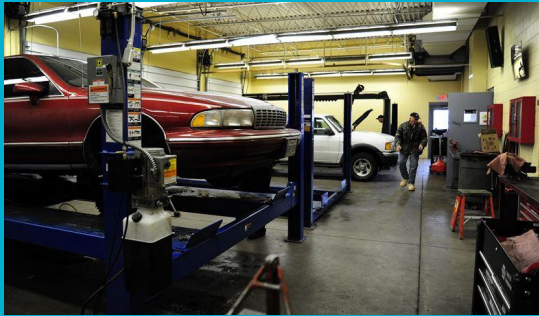

Optimal learning environments are based on the belief that EVERY STUDENT can achieve high expectations. Instruction is strengths-based, culturally responsive and personalized to ensure students meet the demands of grade-level standards.

OPTIMAL LEARNING ENVIRONMENT

Today's schools are challenged to meet the needs of **ALL LEARNERS** within environments that are **responsive to needs** and **strategically leveraged** to support highest levels of learning.

Educates the whole child

Integration of learning across content areas

Ensures equity

Utilizes research-based practices

Creates safe & engaging learning communities

Personalized for learners

Co-constructed by students/adults

CHARACTERISTICS of the Optimal Learning Environment



**Create Emotionally,
Intellectually, and
Physically Safe
Environments**



**Implement Equitable,
Culturally Responsive,
and Standards-Aligned
Curriculum and Instruction**



**Meet the
Diverse Needs
of Every Learner**



**Create Emotionally,
Intellectually, and
Physically Safe
Environments**

Emotionally, Intellectually and Physically Safe Environment

- Classroom relationships based on trust and caring
- Understands that learning is fundamentally social
- Nurtures self-awareness and sense of purpose
- Emphasizes effort, supported risk taking and growth
- Supports safe and engaged teacher-student and student-student interactions
- Encourages strategies for expression of emotion and healthy conflict resolution



**Create Emotionally,
Intellectually, and
Physically Safe
Environments**

Space Implications

- Classroom that supports comfortable learning
- Furniture and arrangement that supports collaboration
- Environment that encourages social interaction
- Classroom zones - quiet learning, group learning, learning with the teacher, full and small group learning, individualized instruction, etc.
- Ability to be personalized and reflective of the learners in the room - displaying work, co-construction of resources
- Areas where learning is showcased and celebrated



**Implement Equitable,
Culturally Responsive,
and Standards-Aligned
Curriculum and Instruction**

Equitable, Culturally Responsive & Standards-Aligned Instruction

- High expectations for all students
- Challenging content aligned to grade-level standards
- Inquiry-based learning to create relevance and personal connection
- Learner variability is understood and welcomed
- Instructional method is responsive to student need
- Engages learners in productive struggle encourage perseverance and learner agency
- Values multiple perspectives



**Implement Equitable,
Culturally Responsive,
and Standards-Aligned
Curriculum and Instruction**

Space Implications

- Sufficient space for a wide variety of activities and setups
- Movement and flexibility is essential for furnishings
- Resources aligned to the content area and available on demand to the teacher and learner:
 - Classroom libraries with variety of books / reading resources
 - Hands-on resources - math manipulatives, science equipment, project supplies, daily student supplies
 - Instructional materials beyond textbooks or workbooks
- Easy access to technology
- Sufficient storage for reduction of visual clutter and organization of learning space
- Access to all areas by all students

Meeting the Needs of EVERY LEARNER



**Meet the
Diverse Needs
of Every Learner**

- Leverage individual strengths to support academic, social and emotional growth
- Providing multiple pathways to learning
- Multiple opportunities and venues to show learning
- Maximize self-directed learning
- Supporting learning for every learner to meet the standards through instructional practices such as:
 - Teacher or Peer Modeling
 - Strategic grouping
 - Questioning
 - Timely and goal-oriented feedback
 - Well-designed practice opportunities
 - Specially designed instruction

Space Implications



**Meet the
Diverse Needs
of Every Learner**

- Variety of seating options for comfort and purpose -
 - standing and seating desks
 - tables and work surfaces that are mobile
 - comfortable seating for independent work
 - variety of seating for different needs
- Areas and furnishings that support social interactions
- Purposeful spaces for full group, small group and independent learning, meeting sensory needs
- Stations / room allocation for different types of tasks
- Organizational systems that support efficient interactions with teacher and independent learning progression
- Access to learning supports - headphones, sensory tools, adaptive technology, etc.

Additional Structures to Support Learning

- Teacher Mentors / Instructional Coaches providing on-the-job coaching
- Frequent and ongoing professional learning for all professionals
- Robust elective offerings
- Vibrant school library
- Inviting student areas - lunch room, playground, personal belonging storage
- Spaces supporting school counseling and behavioral services to students
- Collaboration of professionals to support student learning - Specialists (Special Education, English Learners, Interventionists) + Classroom Teacher
- Families engaged as partners in learning
- Shared resource areas - teacher bookrooms, science labs, equipment storage

Additional Space Needs

Schools are more than
just classrooms!

Place(s) for teacher collaboration -
conference rooms, working lounge

Space designed to provide and support
professional learning

Updated spaces and equipment for
elective areas - gymnasium, music
rooms, art room

Contemporary library

Updated playground & eating area

Smart storage for teacher & student
resources

Spaces that welcome families during
drop off / pick up and engagement with
office staff

In an optimal learning environment, instruction addresses the needs of every learner with attention to equity and continuous academic, social & emotional growth.



collaborative learning spaces



SCHOOL DISTRICT OF



FORT • ATKINSON



Facilities Advisory Committee

student-centered learning

Various Settings and Context

- Different places for learning
- Self learning vs. organized learning
- Multiple learning styles
- Flipped classroom



Facilities Advisory Committee

transforming the learning environment

Learning Environment Goals

- Size would be 900 to 1,200 sq. ft. as compared to 800 to 900 sq. ft.
- Flexible furniture
- Designed with large group, small group and individual study spaces
- Project-based learning would be supported
- Variety of learning environments
- Increased transparency between spaces
- Access to outdoors



transforming the learning environment

Blueprint for **TOMORROW**

Redesigning Schools for
Student-Centered Learning



PRAKASH NAIR

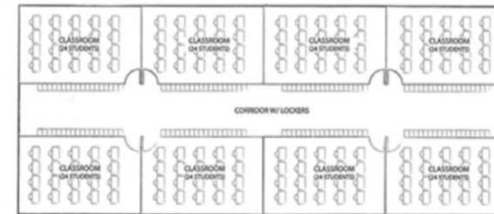

FIGURE 3.10 Typical Classrooms and Hallway Floor Plan

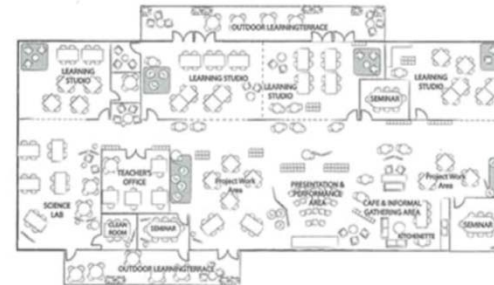

FIGURE 3.11 Transforming the Classroom-Hallway Plan into a Small Learning Community

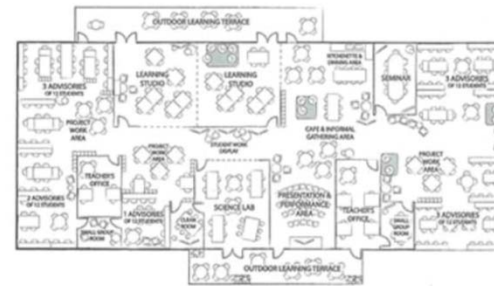
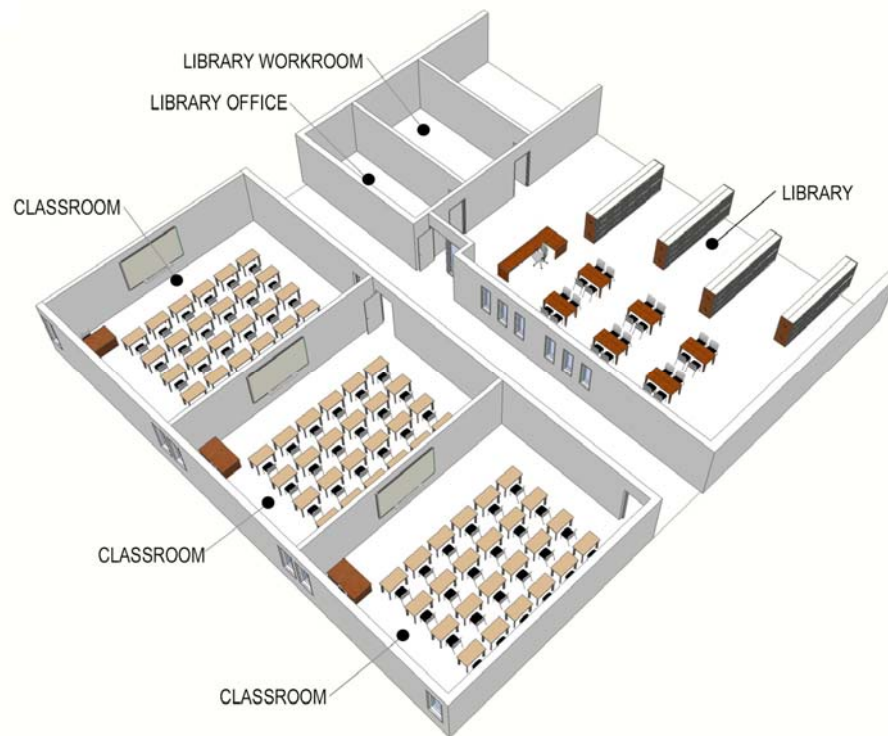

FIGURE 3.12 Transforming the Classroom into an Advisory-Based Small Learning Community

transforming the learning environment

Current Space Configuration



Reconfigured Space

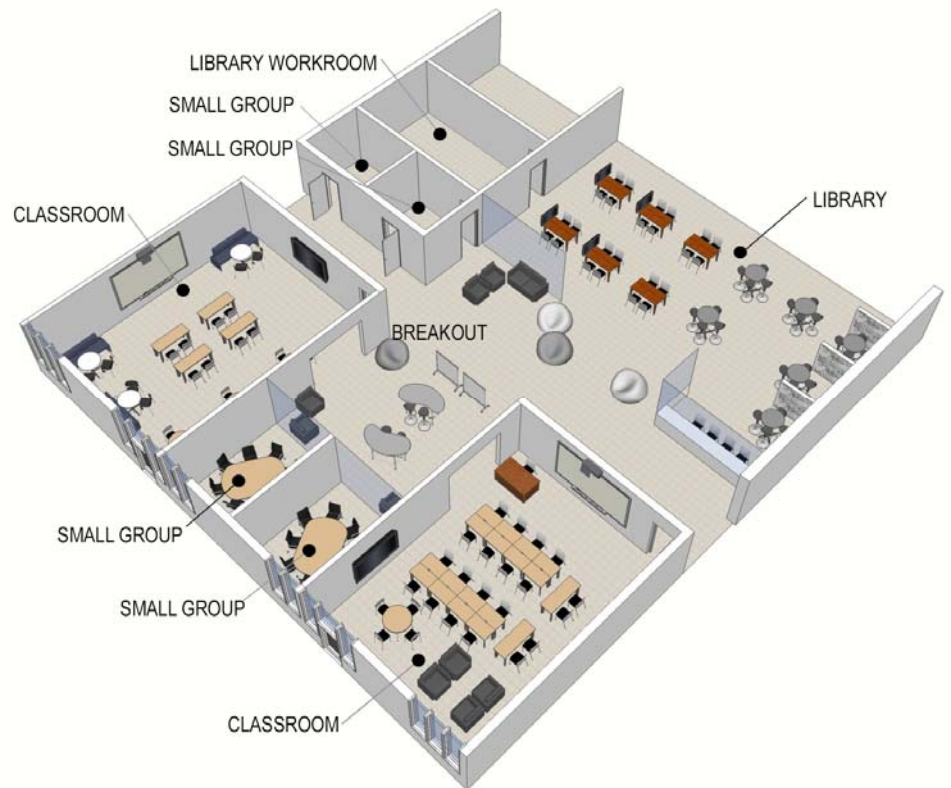

modern learning environments

Program Organization

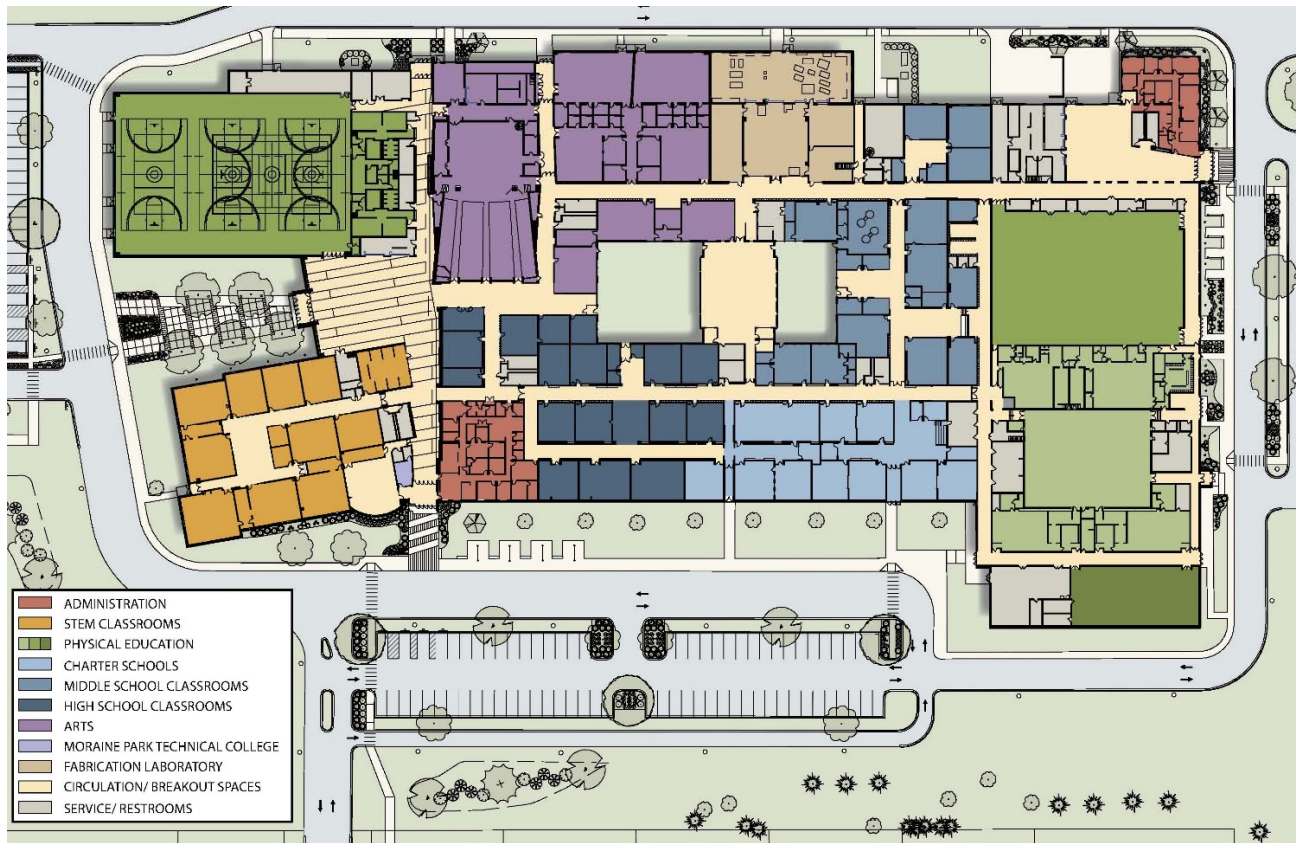

Facilities Advisory Committee

modern learning environments

Student Commons



Facilities Advisory Committee

modern learning environments

Athletic Facilities

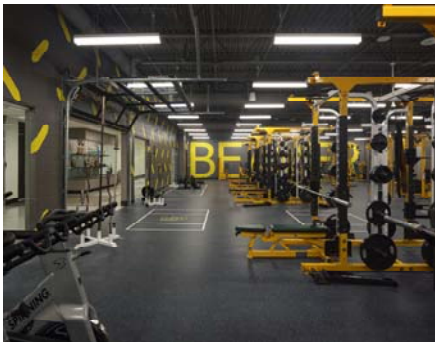
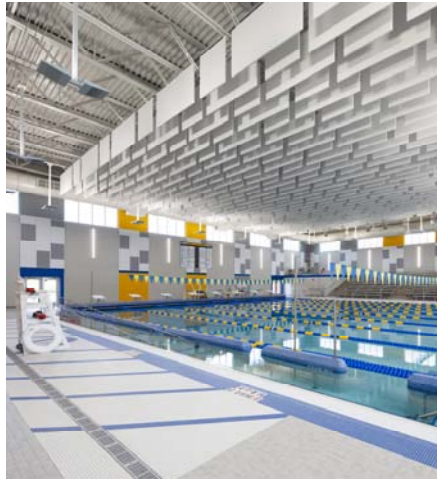

Facilities Advisory Committee

modern learning environments

Performing Arts



es Advisory Committee

modern learning environments

IMC / Learning Commons



Facilities Advisory Committee

modern learning environments

Next Generation Tech Ed



Facilities Advisory Committee

modern learning environments

Next Generation Tech Ed



Facilities Advisory Committee

modern learning environments

STEM Labs



Facilities Advisory Committee

modern learning environments

STEM Labs



Facilities Advisory Committee

modern learning environments

Collaboration Spaces

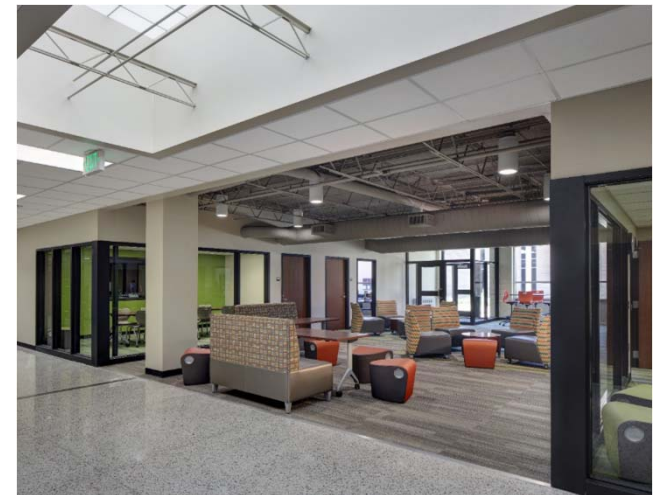

Facilities Advisory Committee

building tour

high school



SCHOOL DISTRICT OF



FORT • ATKINSON

SCHOOL DISTRICT OF



FORT • ATKINSON

FAC Meeting No. 3 | 19 November 2019



CGSCHMIDT

pra

PLUNKETT RAYSICH
ARCHITECTS, LLP